

DUOROLL

Fitting & Operating Instructions

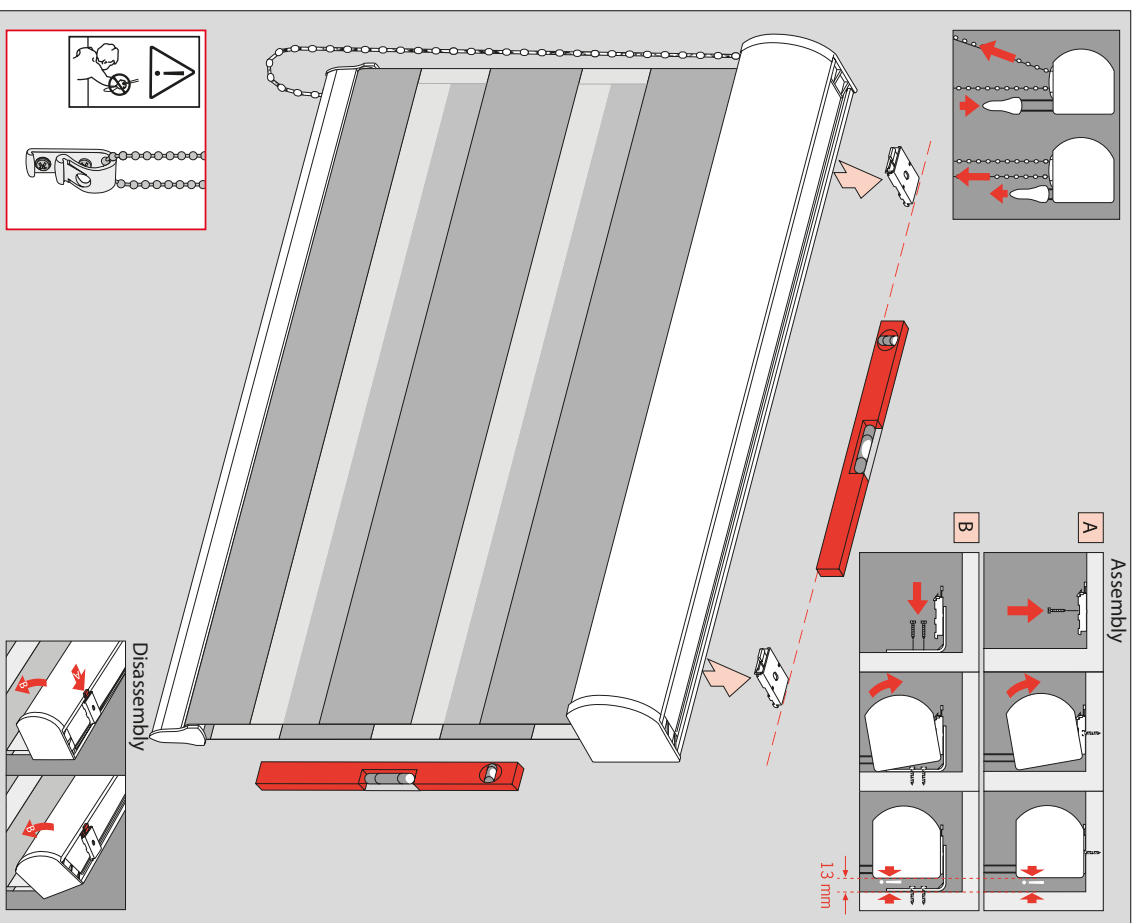

77 665050 0 (02/2014)

WARNING

According to EN 13120

- Young children can be strangled by loops in pull cords, chains, tapes and inner cords that operate the product. They can also wrap cords around their necks.
- To avoid strangulation and entanglement, keep cords out of reach of young children.
- Move beds, cots and furniture away from window covering cords.
- Do not tie cords together. Make sure cords do not twist and create a loop.
- Install and use the included safety devices according to the installation instructions on these devices to reduce possibility of such an accident.

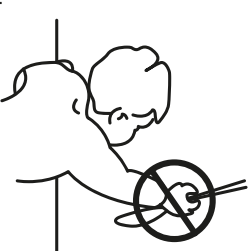

Important! Please keep together with our instructions!

Operating the Blind

In order to raise the blind pull the rearmost length of chain downwards with a smooth and steady pressure. To lower the blind, do the same on the front length of chain.

Note to installer: Please ensure a general shield safety warning tag is fitted on the product. The installation of this product can be completed by non-professionals.

